

Jacob Messersmith

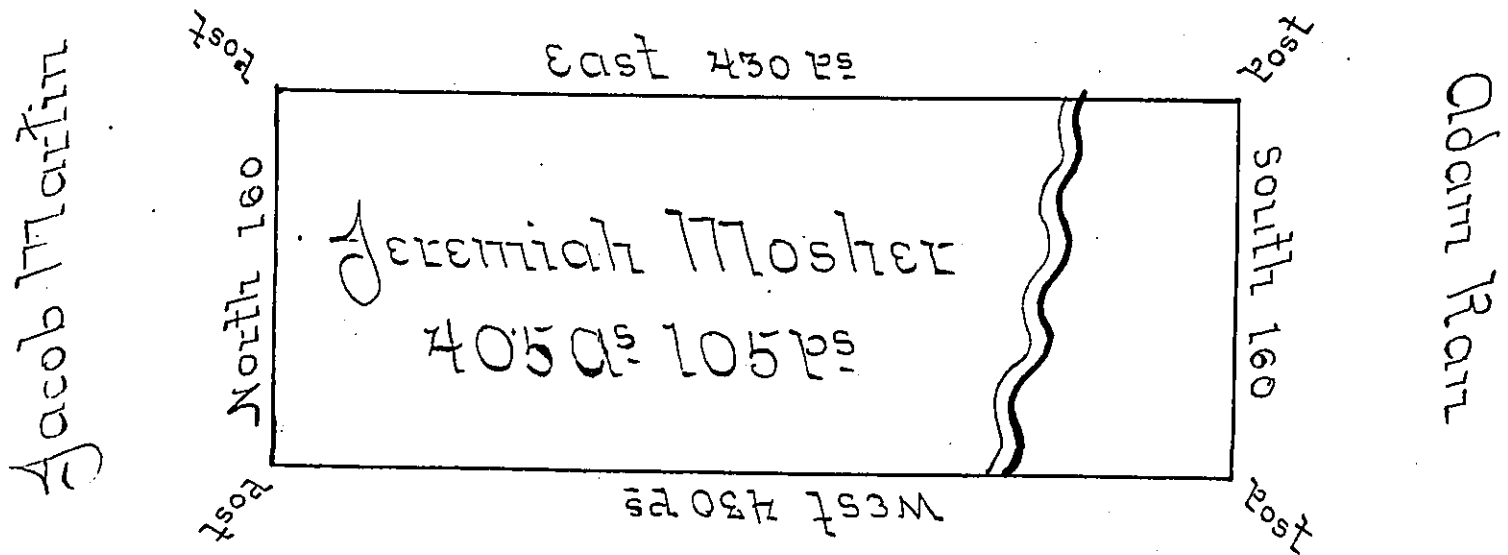

Mathias Young

Situate on Blacklick Creek in Wheatfield Township,  
 Westmoreland County, Containing 405 Acres & 105 Per-  
 ches and Allowance of six Percent for Roads &c Surveyed  
 for Jeremiah Mosher the 19th Day of November 1794  
 on Warrant dated the 3rd Day of May 1793.

Daniel Broadhead Esq. S. J.

James Ross D.S.

*IN TESTIMONY* that the above is a copy of the original remaining on file in  
 the Department of Internal Affairs of Pennsylvania, made  
 conformably to an Act of Assembly approved the 16th day of  
 February, 1833, I have hereunto set my Hand and caused  
 the Seal of said Department to be affixed at Harrisburg,  
 this fourth day of February 1902.

*James W. Latta*  
 Secretary of Internal Affairs.